



---

QUALITY SPECIFICATIONS FOR ROADWAY BRIDGES,  
STANDARDIZATION AT A EUROPEAN LEVEL

# **OWNERS MEETING OF COST ACTION TU1406**

November 22, 2018

Bergisch Gladbach, Germany



ESF provides the  
COST Office through a  
European Commission contract



COST is supported by  
the EU Framework  
Programme



# OWNERS MEETING

## COST ACTION TU1406

QUALITY SPECIFICATIONS FOR ROADWAY BRIDGES,  
STANDARDIZATION AT A EUROPEAN LEVEL

22<sup>nd</sup> of November, 2018

BASt – Federal Highway Research Institute  
Brüderstraße 53, 51427 Bergisch Gladbach, Germany

### ACTION CONTACTS

Chair of the Action  
Vice Chair of the Action  
Local organizer  
Action websites

Prof. José C. Matos  
Prof. Joan R. Casas  
Ralph Holst  
<http://www.tu1406.eu>

[chair@tu1406.eu](mailto:chair@tu1406.eu)  
[vicechair@tu1406.eu](mailto:vicechair@tu1406.eu)  
[holst@bast.de](mailto:holst@bast.de)  
<http://www.cost.eu>

## CONTENTS

1.	Introduction .....	4
1.1.	Objectives.....	4
1.2.	Programme.....	4
1.3.	Location, Dates and Travelling .....	5
1.3.1.	Location and Date .....	5
1.3.2.	How to Reach the Federal Highway Research Institute .....	7
1.3.2.1.	By car .....	7
1.3.2.2.	By train and public transport .....	7
1.3.2.3.	By taxi .....	8
1.3.2.4.	By air .....	8
1.4.	Accommodation.....	8
1.5.	Committees .....	8
1.5.1.	Scientific Committee .....	9
1.5.2.	Organizing Committee .....	9
1.5.3.	Secretariat.....	9
2.	Social Events .....	10
2.1.	Cologne Tour.....	10
2.2.	Networking Dinner .....	10

# 1. INTRODUCTION

## 1.1. OBJECTIVES

COST action TU1406 Quality specifications for roadway bridges, standardization at a European level ([www.tu1406.eu](http://www.tu1406.eu)) is now into its 4<sup>th</sup> year and significant results have been achieved.

The success of this Action can be measured by the impact it has on the civil engineering community composed by, among others, infrastructure owners and operators.

These target groups are the end users who will be able to exploit the outcome of COST Action TU1406 by applying the developed methodology to their assets in order to be maintained in an upscale level.

In order to transmit the required information in a direct and clear manner to end users TU1406 is organizing

In order to reinforce this cooperation, COST Action TU1406 is organizing an Owners Meeting at BAST, Brüderstraße 53, Bergisch Gladbach (near Cologne) in Germany the 22nd of November 2018.

## 1.2. PROGRAMME

---

**Thursday, 22<sup>nd</sup> November**

10:00 – 10:30 Registration

**Session 1**  
**Chair: Poul Linneberg**  
**Co-Chair: Arjen van Maaren**

10:30 – 13:00	<p>Greetings  <i>by Dr. Jürgen Krieger, Head of Department, Bridges and Structural Technology, BAST, DE</i></p> <p>Organizational Points  <i>by Ralph Holst, BAST, DE</i></p> <p>Introduction of COST Action TU1406  <i>by José Matos, UMinho, PT</i></p> <p>Bridge Owners Relevance  <i>by Nicolas Bardou, VINCI Autoroutes, FR and João Amado, Infraestruturas de Portugal, PT</i></p> <p>Performance Indicators &amp; Performance Goals – evaluation and recommendations  <i>by Alfred Strauss, BOKU, AT</i></p> <p>Quality Control Framework  <i>by Rade Hajdin, Uni. Belgrade, RS</i></p> <p>Case-Study  <i>by Amir Kedar, Kedmor Engineers, IL</i></p>
---------------	--

13:00 – 14:00

Lunch and Networking

---

**Session 2**  
**Chair: Niels Peter Høj**  
**Co-Chair: Ralph Holst**

14:00 – 16:00

Case-study

by *Amir Kedar, Kedmor Engineers, IL*

Guidelines and recommendations

by *Helmut Wenzel, Vienna Consulting Engineers ZT GmbH, AT*

Panel discussion with active participation from the audience,

moderated by *Niels Peter Høj (HOJ Consulting GmbH, CH)*

Panel consist of

- *Alfred Strauss (BOKU, AT),*
- *Amir Kedar (Kedmor engineers, IL),*
- *João Amado (Infraestruturas de Portugal, PT),*
- *José Matos (UMinho, PT),*
- *Nicolas Bardou (VINCI Autoroutes, FR),*
- *Poul Linneberg (COWI A/S, DK),*
- *Rade Hajdin (Uni. Serbia, RS),*
- *Ralph Holst (BASt, DE) and*
- *Helmut Wenzel (Vienna Consulting Engineers ZT GmbH, AT)*

Closing

by *Joan Casas, UPC, ES*

16:00 – 16:30

Coffee and Networking

16:30 –

Tour in Cologne followed by Networking dinner

## 1.3. LOCATION, DATES AND TRAVELLING

### 1.3.1. LOCATION AND DATE

The meeting will take place at BASt – Federal Highway Research Institute, located in **Brüderstraße 53, D-51427 Bergisch Gladbach, Germany.**



Fig. 1. Federal Highway Research Institute - BASt

Meeting date is Thursday 22<sup>nd</sup> of November 2018.

The Federal Highway Research Institute - BAST – is a research institute of the Federal Ministry and Digital Infrastructure and has the task of promoting the development of the road sector. With this aim in mind it provides scientifically verified support to the Ministry in decisions on technical issues and transport policy.

BAST conducts its own research to satisfy this function as well as coordinating and supervising research projects and analysing the results.

Founded in 1951 in Cologne, and located in Bergisch Gladbach since 1983, BAST's mission is to improve safety, environmental compatibility, economic efficiency and performance of roads.

Employing around 400 persons and with a budget of approximately 47 million euros per year, BAST consists of five technical departments with a total of 26 sections as well as a testing laboratory for road equipment and calibration laboratory for sensors, central department with five sections, three staff units.

Several hundred overseas guests visit BAST each year to find out about research results and ongoing and planned research. These guests include many delegations of specialists from the areas of public administration and business as well as university representatives. Visiting scientists and university interns come to BAST for study trips lasting a number of weeks. International congresses also facilitate personal contact.

International cooperation is an indispensable component of BAST's work and serves both the exchange of scientific experience and the formation of strategic alliances.

BAST is part of a global network with international institutions. Cooperation agreements with partner institutions form the basis for intensive collaboration.

To ensure high standards, the scientists at BAST are represented in over 200 committees of international organisations.

In addition, BAST collaborates on several European projects.

For more information about BAST, please visit [www.bast.de](http://www.bast.de).

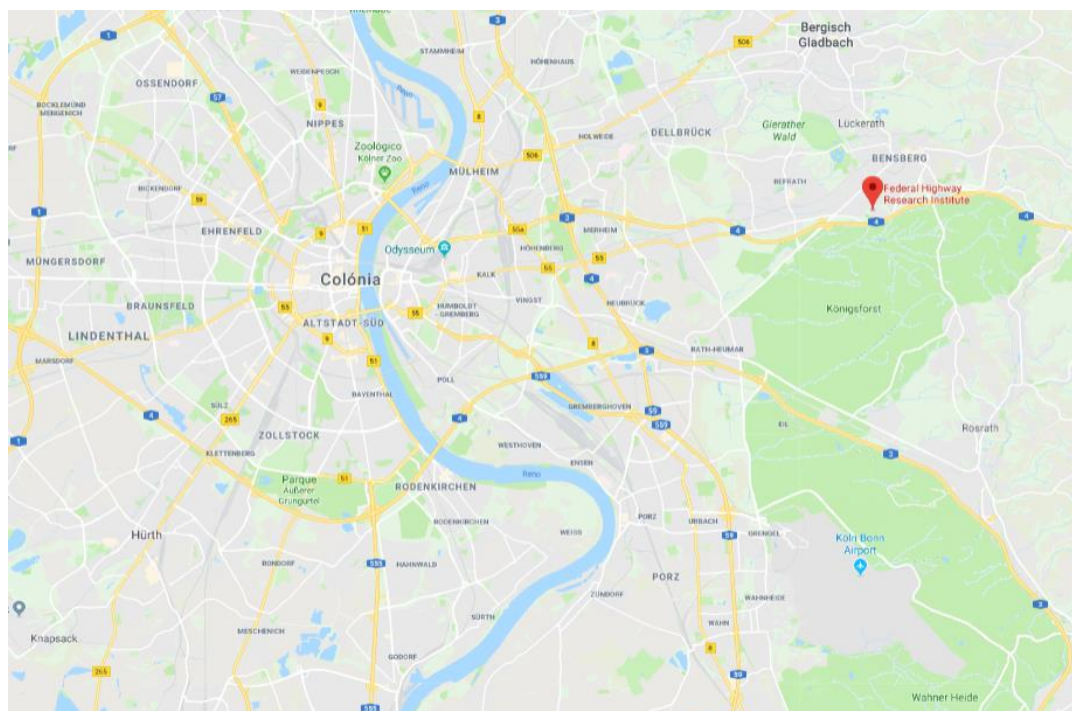

Fig. 2. Location scheme of the meeting Venue

### 1.3.2. HOW TO REACH THE FEDERAL HIGHWAY RESEARCH INSTITUTE

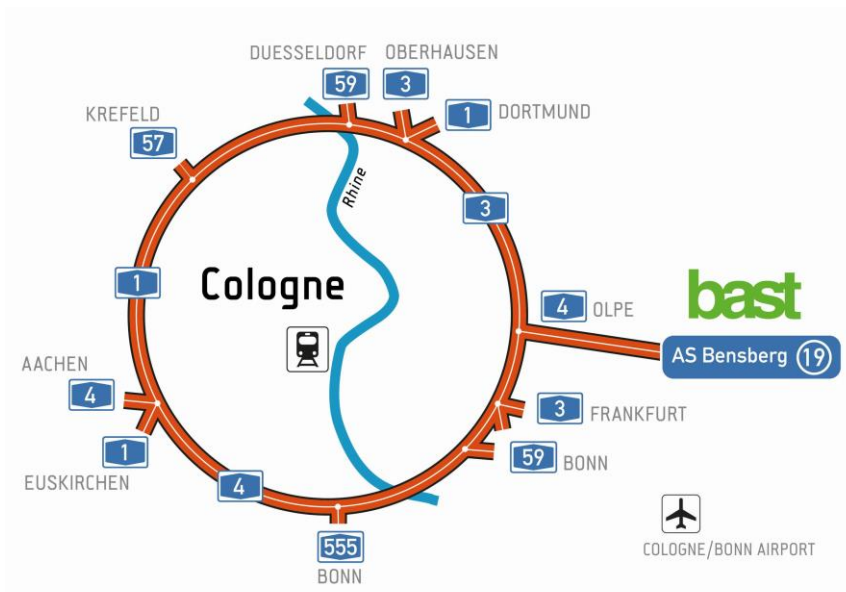

Fig. 3. Federal Highway Research Institute and surrounding area

#### 1.3.2.1. BY CAR

Highway A4 heading from Cologne to Olpe, exit Bensberg (19); follow the signs for Bundesanstalt für Straßenwesen.

#### 1.3.2.2. BY TRAIN AND PUBLIC TRANSPORT

Total journey of about 45 minutes from Cologne.

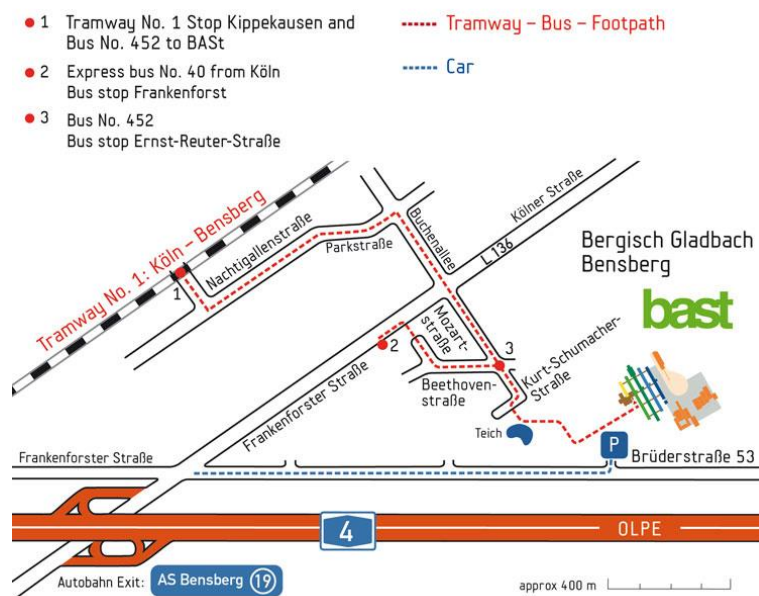

Fig. 4. Federal Highway Research Institute and surrounding area



#### **From Cologne central railway station**

Rapid-transit bus 40 from Breslauer Platz bus stop, destination Bensberg. Travelling time of about 25 minutes to Frankenforst bus stop, followed by a walk of roughly 15 minutes to the Federal Highway Research Institute.

#### **From Köln-Deutz railway station**

Tram line 1, destination Bergisch Gladbach-Bensberg. Travelling time of about 20 minutes to Kippekausen tram stop, by a walk of roughly 20 minutes to the Federal Highway Research Institute. To shorten the walking distance, you can change to: Bus 452, destination Frankenforst. Travelling time of about 5 minutes to the Ernst-Reuter-Straße bus stop, followed by a 5-minute walk to the Federal Highway Research Institute.

Additional information on public transportation services can be obtained at:  
[www.koeln.de/stadinfo/verkehr](http://www.koeln.de/stadinfo/verkehr)

#### **1.3.2.3. BY TAXI**

Travelling time of 20 - 30 minutes.

#### **1.3.2.4. BY AIR**

From Cologne/Bonn airport via public transport Total journey of about 70 minutes.

Regional (S) tram line 13, travelling time of about 15 minutes to the Deutz/Messe tram stop. Continue from Köln-Deutz train station as described above.

or

Onward with regional (S) tram line 13 to the Dom/Hauptbahnhof tram stop, travelling time of about 20 minutes. Continue from Cologne central station as described above.

or

By taxi Travelling time of about 15 minutes.

## **1.4. ACCOMMODATION**

In the city centre Cologne offers a large number of hotels in a wide variety of price categories.

3\*: approx. 60 to 120 €.

4\*: approx. 80 to 180 €

Bookings can be made via known websites (e.g.: [www.hrs.com](http://www.hrs.com), [www.booking.com](http://www.booking.com), [www.hotels.com](http://www.hotels.com), [www.trivago.com](http://www.trivago.com)).

More information is available at: [www.cologne-tourism.com](http://www.cologne-tourism.com)

## **1.5. COMMITTEES**

A scientific committee was defined as well as an organizing committee.



### 1.5.1. SCIENTIFIC COMMITTEE

<i>Name</i>	<i>TU1406 Position</i>	<i>E-mail</i>
<b>José Matos</b>	Chair	chair@tu1406.eu
<b>Joan R. Casas</b>	Vice-chair	vicechair@tu1406.eu
<b>Rade Hajdin</b>	WG3 Leader	wg3@tu1406.eu
<b>Amir Kedar</b>	WG4 Leader	wg4@tu1406.eu
<b>Vikram Pakrashi</b>	WG5 Leader	wg5@tu1406.eu

### 1.5.2. ORGANIZING COMMITTEE

<i>Name</i>	<i>TU1406 Position</i>	<i>E-mail</i>
<b>José Matos</b>	Chair	chair@tu1406.eu
<b>Niels Peter Hoj</b>	IAB Leader	niels.hoj@hoj.ch
<b>Poul Linneberg</b>	IAB Vice-Leader	pli@cowi.com
<b>Ralph Holst</b>	Local Organizer	holst@bast.de
<b>Sérgio Fernandes</b>	TU1406 Support	support@tu1406.eu

### 1.5.3. SECRETARIAT

<i>Name</i>	<i>TU1406 Position</i>	<i>E-mail</i>
<b>Eleni Chatzi</b>	Technical Secretariat	tecsec@tu1406.eu
<b>Sónia Esteves</b>	Administrative Secretariat	admsec@tu1406.eu
<b>Gerd Berthold</b>	Local Support	Berthold@bast.de

## **2. SOCIAL EVENTS**

### **2.1. COLOGNE TOUR**

A bus will pick up the participants at 17:00 at the main entrance of BAST and take them to the old town of Cologne (cathedral, main station).

There will follow an approx. 1 hour old town sightseeing.

A [binding registration](#) is required by 14.11.2018 at the latest.

### **2.2. NETWORKING DINNER**

The dinner will take place at the Brauhaus "Gaffel am Dom" ([www.gaffelamdom.com](http://www.gaffelamdom.com)). There are tables reserved from 18:30 to about 22:00. There will be specialities from the Cologne area, which can be ordered a la carte.

Payment will be made on site by the participants themselves.

A [binding registration](#) is required by 14.11.2018 at the latest.



**TU1406**  
COST ACTION

[WWW.TU1406.EU](http://WWW.TU1406.EU)